

U.S DEPARTMENT OF COMMERCE
NATIONAL OCEANIC AND ATMOSPHERIC ADMINISTRATION
NATIONAL WEATHER SERVICE

WS FORM B-44
(Page 1)

REPORT COOPERATIVE STATION

Rendition: 7

Network: AB

IDENTIFICATION SECTION

Station Name: SAN JACINTO RS
State: CALIFORNIA
County: RIVERSIDE
Latitude: 33 Deg 47 Min N
Longitude: 116 Deg 58 Min W
Time Zone: PACIFIC
Station Begin Date: 12/ 1/1938
Equipment is Located at:
132 S SAN JACINTO AVE WITHIN AND .3 MI NNW OF PO AT SAN JACINTO, CA

Station No: 04-7813-6
Station Type: 92
Township: 4S
Elev: 1560 ft MSL
Zero Datum:
Hydrologic Unit No: 18070202
River Basin: SOUTH COAST

SID: SJRC1
Region: W
Range: 1W
Section: 35

OBSERVER SECTION

Observer 1:
CALIFORNIA STATE DEPT. OF FORESTRY
ATTN: WEATHER OBSERVER
132 SO. SAN JACINTO AVE.
SAN JACINTO, CA

DOS: 9/ 9/1942
92383

Gender: I
Telephones
Home: - -
Office: 714-654-7912

Observer 2:
DOS:
Gender:

STATION MANAGEMENT SECTION

CPM: SAN
ElTech:

WSFO/AM: LAX
Network Mgr: SAN

Hydro Service Area: LAX
Warning Office: LAX
RFC: CNRFC

EXPOSURE/TOPOGRAPHY/DIRECTION SECTION

Exposure (AZIMUTH/RANGE/ELEV Nomenclature):
CRS 20/5 TREES 270-90/15/34 F.S. 170/50/0 BLDG 200/150/0

Topography:
LEVEL BASIN; RESIDENTIAL AREA; MTNS NE-SE 4-5 MI.

Driving Directions:
FM SAN JACINTO & MAIN; SAN JACINTO N 0.2 MI TO F.S. ON LFT.

MISCELLANEOUS SECTION

Remarks:

Reason for Report:
10. CSSA VALIDATION B44.

Effective Date: 04/08/86
Date of Change: 04/14/86

Authorization: AB NET 7/19/55
B44 Signature: CARL W. FREEMAN, CPM/SAN

INSTRUCTIONS FOR USE OF WB FORM 531-1

A report on WB Form 531-1 should be prepared for the establishment, discontinuance or any change in a substation within the hydroclimatic network. (This form is required in addition to Forms 531-4 and 531-6). A complete copy will be made the first time this form is prepared and whenever any piece of equipment is moved in any respect. It will be designated as "Complete rendition No. 1", other spaces remaining blank. Later minor changes (where no equipment is moved) can be shown by filling in pertinent blanks only (e.g., "Supplement letter 'A'", "To complete No. 1", the second supplement will be "B" to "complete No. 1", etc., complete rendition space remaining blank.) When the next move of any instrument or other major change is made, a complete rendition is necessary and should be designated as No. 2, etc. A supplemental rendition, if used, should completely describe the minor change. This report should be prepared by the Field Aide (HC) or other Weather Bureau employee at the time the action is effected. In case the equipment is relocated by the observer, he should be requested to furnish sufficient information for a complete report. The employee effecting the action will submit draft copy of Form 531-1 to RSMS in whose region the station is located, for typing and distribution. The original copy will be forwarded to the Central Office, with copies to NWRC, all other interested offices, and one for the Field Aide's (HC) file. NOTE: In completing "OC-CASION FOR THIS REPORT" Item 2 "Relocation of Equipment" should not be checked if relocation breaks record. In this case use Item 1, "Establishment" and Item 3 "Discontinuance" with separate forms.

SKETCH OF INSTRUMENT LOCATION: To begin sketch, attach Form 531-1 to clip board and place on top of rain gage with top of form towards north using the rain gage as the center of sketch area. Step off distance of each obstruction from gage. Using a scale of 1 inch to 100 feet, sketch the obstructions in their respective locations, with regard to direction and distance from the gage. Place a clinometer level on top of clip board and sight the angle of each obstruction from top of gage to top of obstruction. Indicate the angle of obstruction on a straight line drawn from the gage toward the object. Make detail sketch of location of instrumental equipment in lower left-hand corner of sketch area. A new diagram is required (even when substation is closed) whenever the old sketch does not accurately represent the exposure of the instruments.

STATION NAME: San Jacinto, California

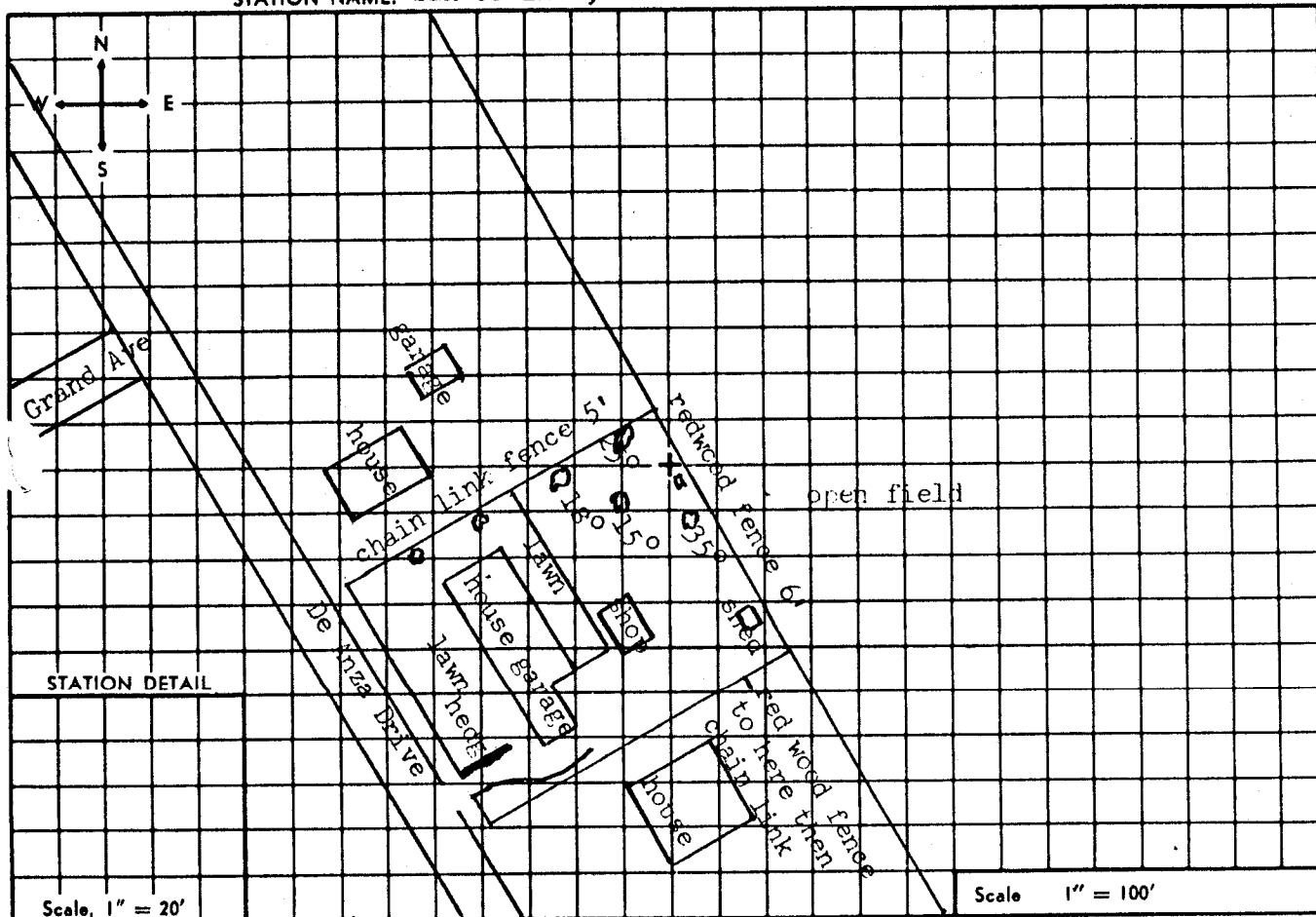

TOPOGRAPHY: (State briefly the general nature of the topography within 3 to 5 miles radius.)

Level area. Shielded from wind by 6' redwood fence N thru E, and in other directions by buildings and trees. San Jacinto Mtns N thru E, 3 miles. Mostly level valley other directions.

DIRECTIONS FOR REACHING STATION: Give instructions in detail. If outside town or city, give direction and distance, highway number or name, and any other pertinent information which will enable the inspector to drive directly to the station without previous knowledge of its location. From center of town, Main and San Jacinto Blvd, go W on Main for 0.35 mile turn right (45°) onto De Anza Drive go 0.4 mile to observers residence on the right side of street (575 De Anza). Station at rear of lot.